

## Chairman's Report 31 December 2023 to 31 December 2024

It's been another busy year for the Playing Fields Committee, organising the many social events throughout the year and progressing our new development project. A new sub-committee has been formed, primarily to raise funds to meet the cost of the Playing Fields Development Project.

### TOWERSEY PLAYING FIELD DEVELOPMENT PROJECT

#### Site Plan



The Site Plan shows:

The car park extended to the west as far as the children's play area. A new path connects the children's play area to the new pavilion. The path is separated from the car park by new hedging.

The new pavilion is set at an angle to make the most of the view of the playing field and the children's play area.

The new storage unit is located beyond the entrance to the allotments along the eastern boundary.

The site plan shows the approximate location of new trees (dark shading) and existing trees (light shading) to be retained.

## **New Storage Unit**

After several delays, mainly due to the very wet spring and early summer, construction of the new unit started in July and the building was erected in August just in time for it to be used following the Fringe. The unit measures 18m x 6m x 3m high to the ridge, with capacity to replace the existing containers and the garage currently on the site.

The Storage Building is located just beyond the entrance to the allotments – see the site plan above. The Playing Fields Committee will manage the day-to-day management of the facility and work together with the other village organisations to determine what will be stored in the new premises. Our thanks go to the Parish council for funding new building.



## **Containers**

As already mentioned, the new storage unit will replace two containers and a garage. The garage will be dismantled. Interest in the containers has been expressed by two separate parties who will be removing them from site shortly.

## **New Pavilion**

SODC's Planning Department granted planning permission on 16 April 2024.

A number of conditions were included in the planning consent to be submitted to SODC prior to commencement of any construction work, as follows:

- Detailed tree survey
- Biodiversity Enhancement Plan
- Surface and foul water drainage schemes
- External lighting scheme
- Acoustic insulation and mitigation report
- Sustainability Assessment (BREEAM)

Consultants will be engaged to work alongside our architects to produce the necessary documents.

With the granting of Planning Consent the Playing Fields Committee (PFC) can now formally start to apply for grant aid. This work is largely completed with the preparation of formal documentation, such as a business plan, reports detailing evidence of a need for such a project, benefits to the community, etc.

The PFC has already retained the services of a funding consultant to assist with applications for grant funding. The estimated funding required is in excess of £1.2m

Architects' drawings and 3D renditions of the new pavilion were on display at the Fringe and Towersey Memorial Hall during the year, with committee members on hand to explain the structure and the facilities to be provided. Some of the illustrations on display are reproduced below.

### Floor Plan

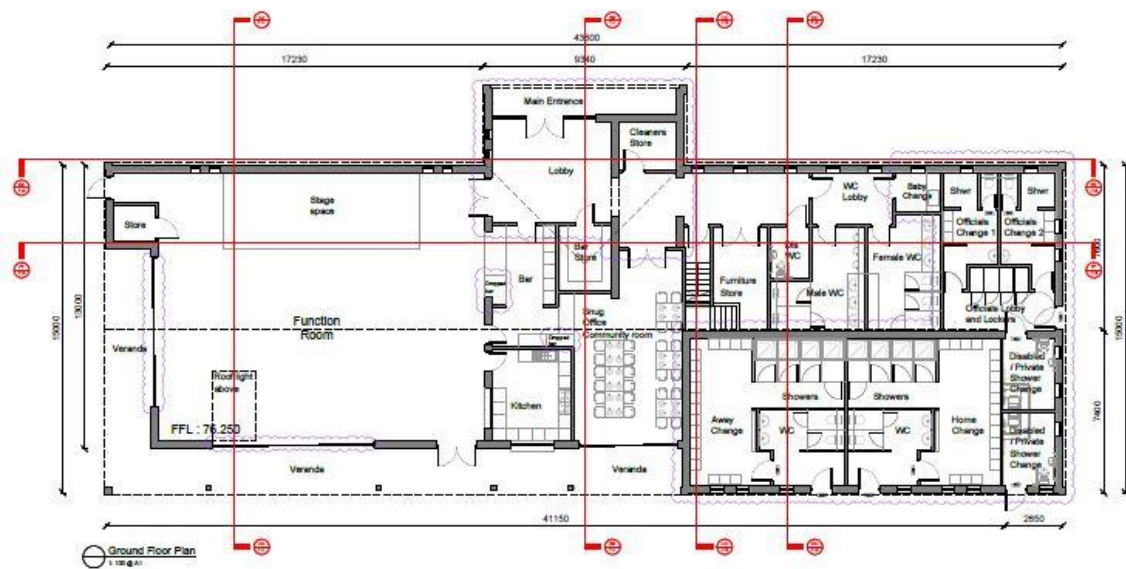

### The New Pavilion as seen from the Car Park



**The Function Room showing the bar and Kitchen serving areas.**



## **Annual Events**

### **Towersey Fringe**

The TPF committee would like to give a big thank you to the Fringe Committee and all the volunteers, and congratulations for another fantastic event.

For such a small village the event is a phenomenal achievement by the Fringe Committee and all the helpers. This year over £36,000 was raised. All the profits from which goes towards the playing fields development project, helping us achieve our goal of providing a first class sports and leisure facility for the village.

### **Progressive Supper**

A progressive Supper was held in April, which started at Towersey Memorial Hall (TMH), then the participants moved on to the first venue for a starter. Then to a second venue for the main course, ending up back at the TMH for drinks to wind up the evening. This event is always thoroughly enjoyed by everyone involved and raises useful funds that go towards The Playing Field maintenance costs.

## **Maintenance**

### **Grass Cutting**

Grass cutting is carried out by the playing field committee's sub-contractor generally twice a month during the growing season and up to once a month at other times.

### **Children's Play Area**

Some repair work was necessary this year on the 'trim trail' as notified by our Annual RoSPA (Royal Society for the Prevention of Accidents) inspection.

Wood chippings around the swings and climbing equipment, etc was renewed this December by the committee and a team of volunteers from the village.

## **Plans for 2025**

- Trim the hedges around the boundary and children's play area.
- Investigate a more permanent alternative to the wood chips in the children's play area.
- Complete the planning consent preconditions
- Obtain quotations from construction companies and obtain funding to allow construction to start.

*Richard Duckham  
towerseypfc@gmail.com*



## Receipts and payments accounts

CC16a

For the period  
from

1st Nov 2023

To

31st Oct 2024

### Section A Receipts and payments

	Unrestricted funds to the nearest £	Restricted funds to the nearest £	Endowment funds to the nearest £	Total funds to the nearest £	Last year to the nearest £
<b>A1 Receipts</b>					
Rentals	815	-	-	815	400
Donations	38,909	-	-	38,909	41,316
Fund-Raising Events	5,562	-	-	5,562	1,850
Grants	-	-	-	-	-
Interest Received	1,306	-	-	1,306	1,036
Other	-	-	-	-	173
	-	-	-	-	-
	-	-	-	-	-
<b>Sub total (Gross income for AR)</b>	<b>46,592</b>	<b>-</b>	<b>-</b>	<b>46,592</b>	<b>44,775</b>
<b>A2 Asset and investment sales, (see table).</b>					
	-	-	-	-	-
	-	-	-	-	-
<b>Sub total</b>	<b>-</b>	<b>-</b>	<b>-</b>	<b>-</b>	<b>-</b>
<b>Total receipts</b>	<b>46,592</b>	<b>-</b>	<b>-</b>	<b>46,592</b>	<b>44,775</b>
<b>A3 Payments</b>					
Repairs & Maintenance	4,510	-	-	4,510	2,906
Fund Raising Event expenses	1,532	-	-	1,532	1,385
Utilities ,Rates & Insurance	999	-	-	999	1,703
Project Expenses	19,839	-	-	19,839	11,461
Other	154	-	-	154	95
	-	-	-	-	-
	-	-	-	-	-
	-	-	-	-	-
	-	-	-	-	-
<b>Sub total</b>	<b>27,034</b>	<b>-</b>	<b>-</b>	<b>27,034</b>	<b>17,550</b>
<b>A4 Asset and investment purchases, (see table)</b>					
	-	-	-	-	-
	-	-	-	-	-
<b>Sub total</b>	<b>-</b>	<b>-</b>	<b>-</b>	<b>-</b>	<b>-</b>
<b>Total payments</b>	<b>27,034</b>	<b>-</b>	<b>-</b>	<b>27,034</b>	<b>17,550</b>
<b>Net of receipts/(payments)</b>	<b>19,558</b>	<b>-</b>	<b>-</b>	<b>19,558</b>	<b>27,225</b>
A5 Transfers between funds	-	-	-	-	-
A6 Cash funds last year end	145,477	-	-	145,477	118,252
<b>Cash funds this year end</b>	<b>165,035</b>	<b>-</b>	<b>-</b>	<b>165,035</b>	<b>145,477</b>

### Section B Statement of assets and liabilities at the end of the period

Categories	Details	Unrestricted funds to nearest £	Restricted funds to nearest £	Endowment funds to nearest £
<b>B1 Cash funds</b>	Cash in Bank	165,035	-	-
		-	-	-
		-	-	-
	<b>Total cash funds</b>	<b>165,035</b>	<b>-</b>	<b>-</b>
	(agree balances with receipts and payments account(s))	OK	OK	OK
		Unrestricted funds to nearest £	Restricted funds to nearest £	Endowment funds to nearest £

**B2 Other monetary assets**

	-	-	-
	-	-	-
	-	-	-
	-	-	-
	-	-	-
	-	-	-

**B3 Investment assets**

Details	Fund to which asset belongs	Cost (optional)	Current value (optional)
		-	-
		-	-
		-	-
		-	-
		-	-

**B4 Assets retained for the charity's own use**

Details	Fund to which asset belongs	Cost (optional)	Current value (optional)
		-	-
		-	-
		-	-
		-	-
		-	-
		-	-
		-	-
		-	-
		-	-

**B5 Liabilities**

Details	Fund to which liability relates	Amount due (optional)	When due (optional)
Unpresented Cheques	Unrestricted	-	
		-	
		-	
		-	
		-	

Signed by one or two trustees on behalf of all the trustees

Signature	Print Name	Date of approval



**Section A**

**Independent Examiner's Report**

**Report to the trustees/  
members of**

Charity Name  
Towersey Playing Fields Management Committee

**On accounts for the year  
ended**

31<sup>st</sup> October 2024

**Charity no  
(if any)**

1054125

**Set out on pages**

Separate attachment

I report to the trustees on my examination of the accounts of the above charity ("the Trust") for the year ended **31 / 10 / 2023**.

**Responsibilities and  
basis of report**

As the charity trustees of the Trust, you are responsible for the preparation of the accounts in accordance with the requirements of the Charities Act 2011 ("the Act").

**Independent  
examiner's statement**

I report in respect of my examination of the Trust's accounts carried out under section 145 of the 2011 Act and in carrying out my examination, I have followed the applicable Directions given by the Charity Commission under section 145(5)(b) of the Act.

I have completed my examination. I confirm that no material matters have come to my attention (other than that disclosed below \*) in connection with the examination which gives me cause to believe that in, any material respect:

- accounting records were not kept in accordance with section 130 of the Act or
- the accounts do not accord with the accounting records

I have no concerns and have come across no other matters in connection with the examination to which attention should be drawn in order to enable a proper understanding of the accounts to be reached.

\* Please delete the words in the brackets if they do not apply.

**Signed:**

**Date:**

02/04/2025

**Name:**

ELINOR SMITH

**Relevant professional  
qualification(s) or body  
(if any):**

CIMA

**Address:**

5 LEISLER GARDENS  
TROWBRIDGE  
WILTSHIRE. BA14 7WJ

Only complete if the examiner needs to highlight matters of concern (see CC32, Independent examination of charity accounts: directions and guidance for examiners).

**Give here brief details of any items that the examiner wishes to disclose.**